



For Lease

Inner Sunset

Prime Corner Retail Space

Jay Pon
415.701.2636
jpon@jps.net

Mark McNee
415.701.2637
mark@mcnee.us

Facsimile: 415.701.2686

555 Irving Street (Corner of 7th Avenue)

Available Spaces : **Unit 1:** ~~919*~~ square feet — **Leased!**
Unit 2: 977* square feet — \$3.75 per SF, NNN
Unit 3: 1,011* square feet — **Leased!**

**Per Owner*

Zoning: Inner Sunset NCD
(See §730.1 of the San Francisco Planning Code)

- Rare corner opportunity along Irving Street
- Irving street shopping district; Excellent foot traffic
- Easy access to MUNI buses and light rail
- Building constructed in 2003
- Public parking lot within 125 feet of property

Term: 5-10 years

Expenses: NNN costs are approximately \$0.60/SF/Month

Levi's Plaza-Van Ness Corridor



PARAGON
REAL ESTATE GROUP

www.SFrealstate.com

The information contained herein has been obtained from sources we deem reliable but is not guaranteed. Prospective purchasers and/or tenants are advised to independently verify accuracy and to review any disclosure information on file with this office. This property statement is dated November 18, 2009 and replaces any previously dated or undated version. Information on this statement changes periodically; Prospective purchasers and/or tenants are advised to contact our office to ensure they have the most current property statement. Square footage should be verified by purchaser and/or tenant using qualified professionals. To be removed from our distribution list call 415.701.2636. Paragon Real Estate Group DRE# 01443761; Jay Pon DRE# 01203843; Mark McNee DRE# 01464307.

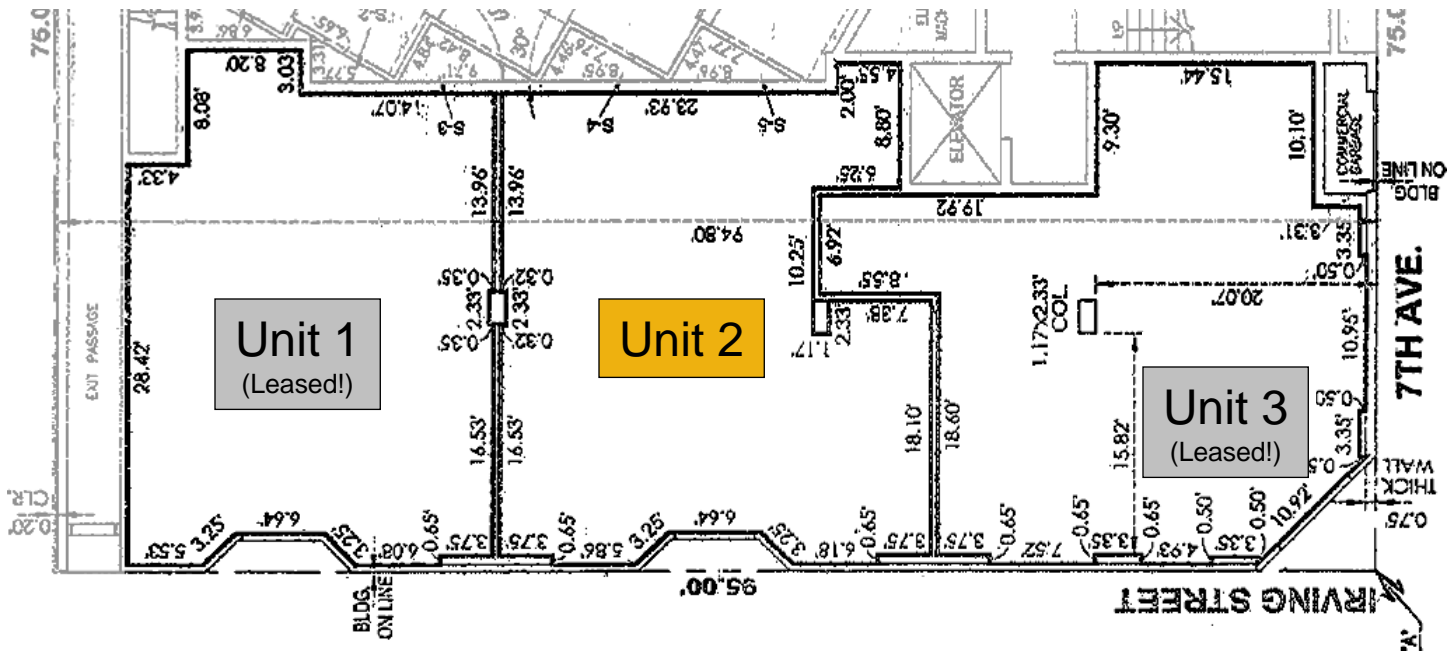
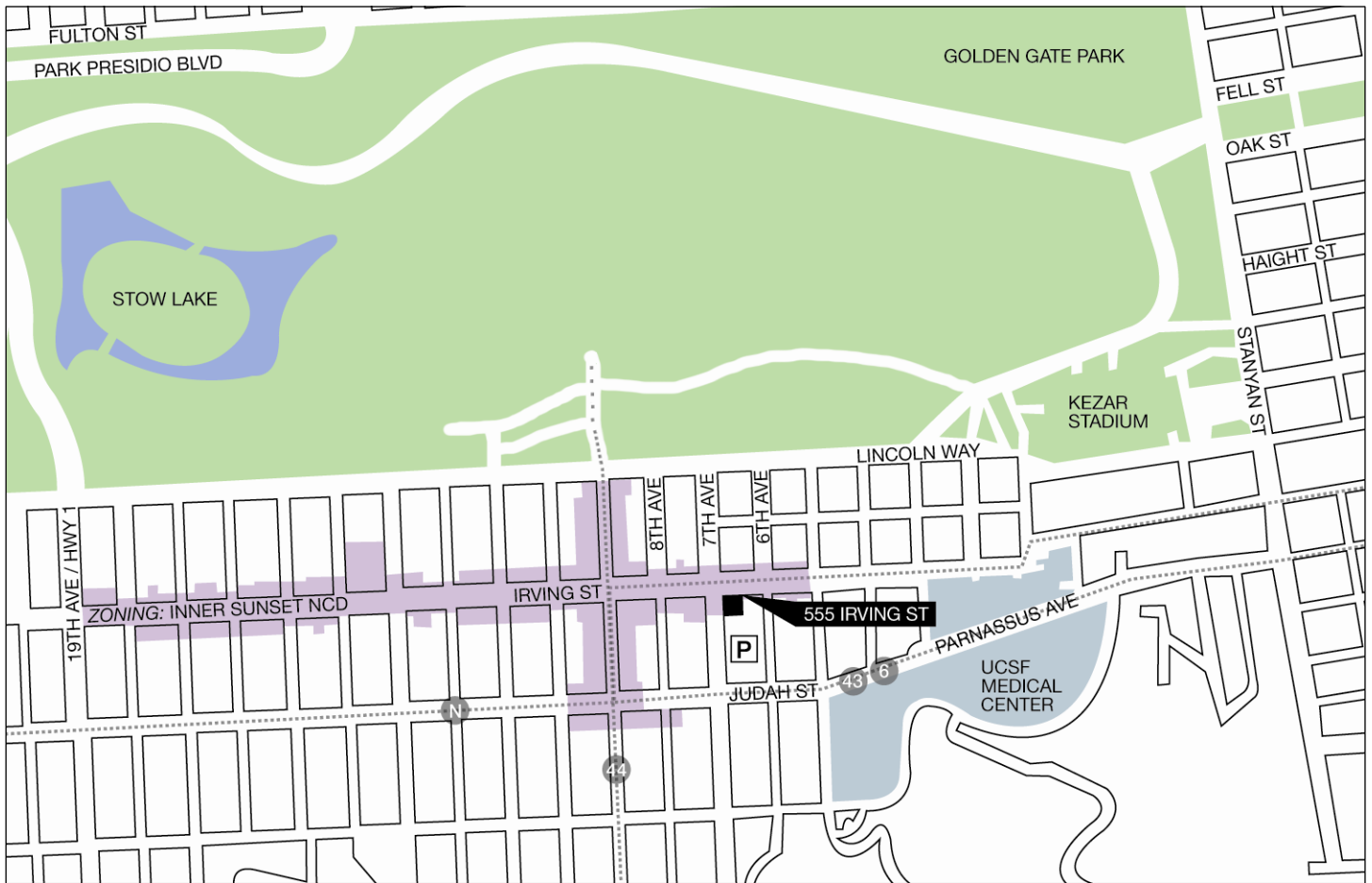

Levi's Plaza - Van Ness Corridor



PARAGON
REAL ESTATE GROUP

www.SFrealstate.com

The information contained herein has been obtained from sources we deem reliable but is not guaranteed. Prospective purchasers and/or tenants are advised to independently verify accuracy and to review any disclosure information on file with this office. This property statement is dated November 18, 2009 and replaces any previously dated or undated version. Information on this statement changes periodically; Prospective purchasers and/or tenants are advised to contact our office to ensure they have the most current property statement. Square footage should be verified by purchaser and/or tenant using qualified professionals. To be removed from our distribution list call 415.701.2636. Paragon Real Estate Group DRE# 01443761; Jay Pon DRE# 01203843; Mark McNee DRE# 01464307.